

REMOVABLE GRP ROOF

ROOF TO HAVE EXPLOSION RELIEF FITTINGS

EAVES VENTILATION TO BE PROVIDED TO 3 SIDES (REAR & SIDES)

2400 room ht

LOCKING COVER

FRONT ELEVATION

REAR ELEVATION

SIDE ELEVATION

SUBSTATION DOORS TO MEET SPECIFICATION WITH VENTILATION OPENINGS, IN 2590x2400mm HIGH BRICKWORK OPENING

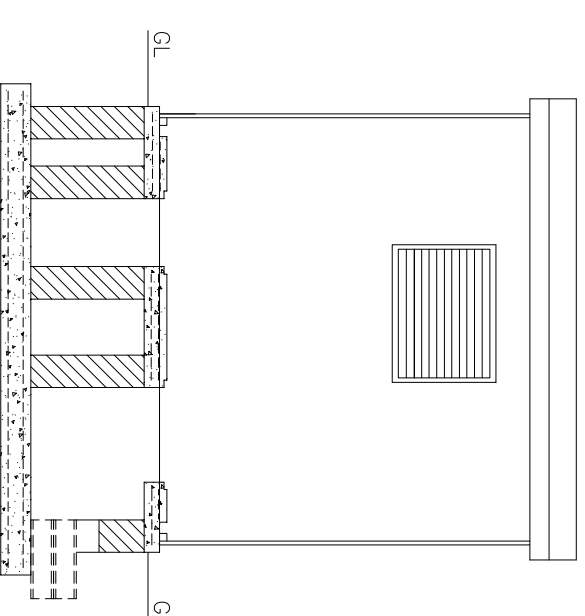

SECTION A-A

50 x 200mm REBATE TO ACCEPT PREFABRICATED ENCLOSURES

NOTE

Substation doors to be set back a minimum of 1500mm from back edge of footprint. Any proposed reduction in this clearance to be approved by Northern Powergrid following submission of site specific risk assessment and operational method statement.

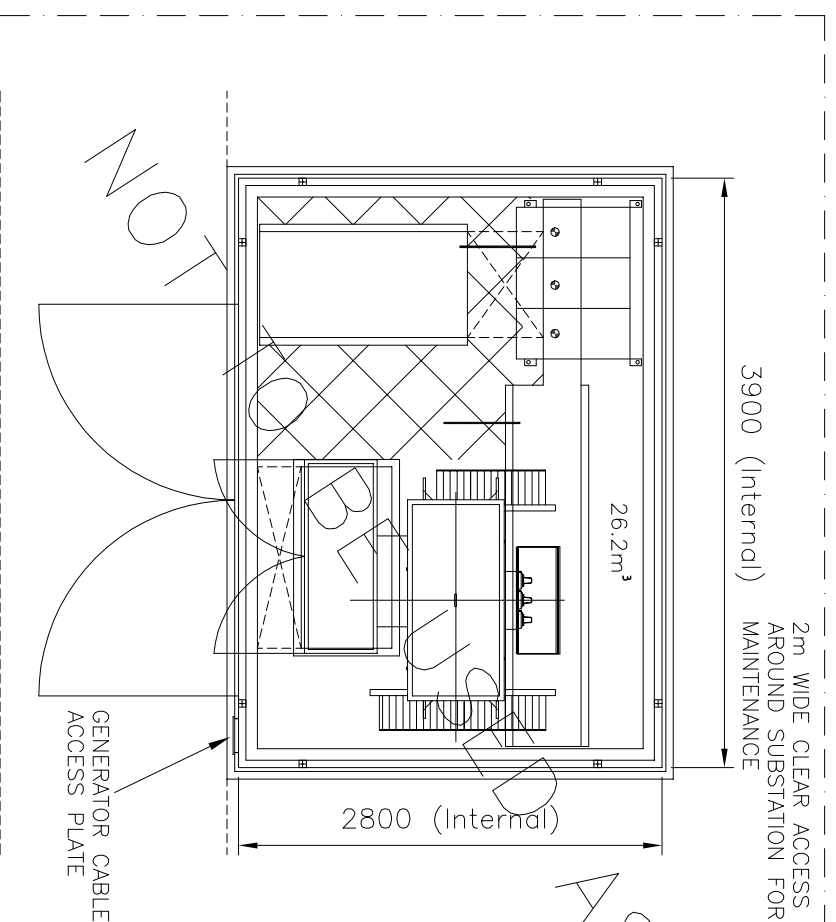

ELECTRICAL LAYOUT

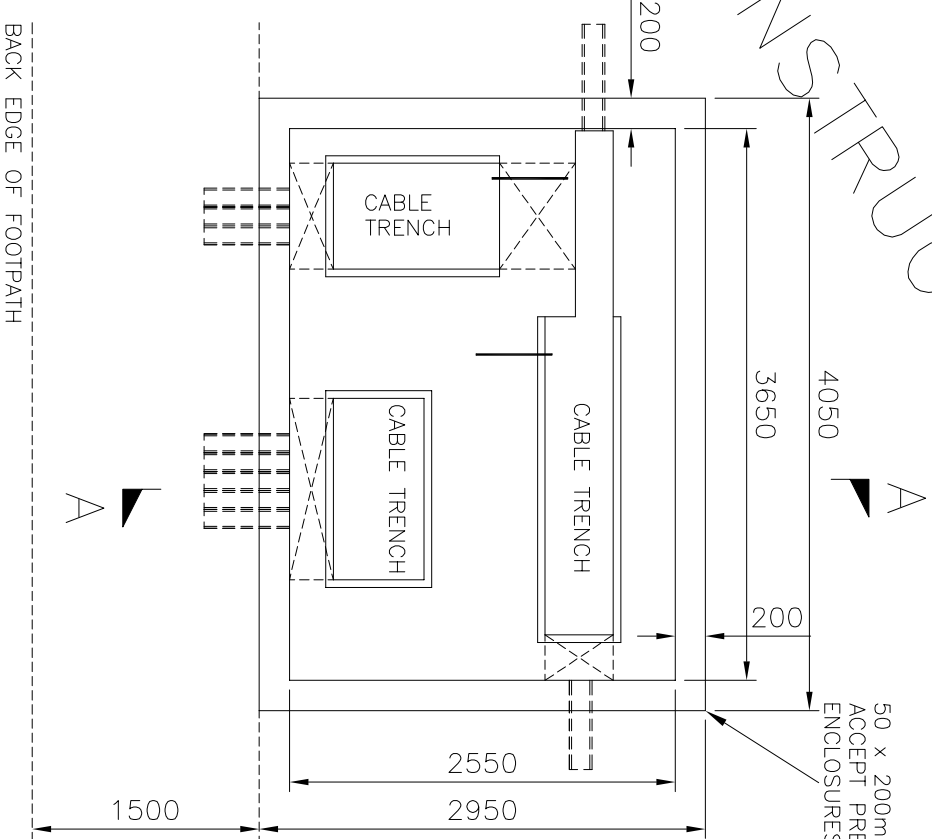

PLAN

BACK EDGE OF FOOTPATH

NORTHERN POWERGRID

Lloyds Court, 78 Grey Street, Newcastle Upon Tyne, NE1 6AF

20kV DISTRIBUTION SUBSTATION IN PREFABRICATED ENCLOSURE

Manufacturer Details
Sheet No. 1
Scale AS SHOWN

Prepared By TM
Grid Reference

Revised
Date Issued 17.05.16
Checked By JJ

Document Details
Ref No. C993898
Revision B
Notes

GENERAL ARRANGEMENT / PLAN & ELEVATIONS

Historic Drawing No.

C993898

Date Issued 17.05.16

Checked By JJ

Revision B

Notes